

# WEST BANKS

TL 600 & 5200 TOWNSHIP 2 NORTH, RANGE 4 WEST, SEC. 36 W.M.  
CITY OF BANKS, WASHINGTON COUNTY, OREGON



### REVISIONS

NO.	DATE	DESCRIPTION
-----	------	-------------

**GROSS ACREAGE: 30.29 AC**

### BENCHMARK:

WASHINGTON COUNTY BENCHMARK NO. 556,  
A BRASS DISK LOCATED AT THE SW CORNER  
OF THE BRIDGE ON NW CEDAR CANYON RD,  
400' WEST OF HWY 47.

ELEVATION DATUM: NGVD 29, ELEVATION = 200.615

### UTILITIES & SERVICES:

WATER:	CITY OF BANKS WATER
STORM:	CLEAN WATER SERVICES
SEWER:	CLEAN WATER SERVICES
POWER:	PORTLAND GENERAL ELECTRIC
GAS:	NORTHWEST NATURAL
FIRE:	BANKS FIRE DISTRICT
POLICE:	CITY OF BANKS
SCHOOL:	BANKS SCHOOL DISTRICT
PARKS:	CITY OF BANKS
PHONE/FIBER:	ZIPLY
WASTE DISPOSAL:	SWATCO SANITARY SERVICE
PHONE:	COMCAST

### APPLICANT:

DAVID WEEKLY HOMES  
1905 NW 169TH PL, SUITE 102  
BEAVERTON, OR 97006  
[P] 503-964-6507  
CONTACT: MAX BONDAR

### SURVEYOR:

PACIFIC COMMUNITY DESIGN, INC.  
12564 SW MAIN ST.  
TIGARD, OR 97223  
[P] 503-941-9484  
CONTACT: TRAVIS JANSEN, PLS, PE

### PLANNER:

PACIFIC COMMUNITY DESIGN, INC.  
12564 SW MAIN ST.  
TIGARD, OR 97223  
[P] 503-941-9484  
CONTACT: PEYTON JAMES/STACY CONNERY, AICP

### CIVIL ENGINEER:

PACIFIC COMMUNITY DESIGN, INC.  
12564 SW MAIN ST.  
TIGARD, OR 97223  
[P] 971-727-4138  
CONTACT: JAKLIN HUNT, PE

### GEOTECHNICAL ENGINEER:

GEOPACIFIC ENGINEERING INC.  
14835 SW 72ND AVENUE  
PORTLAND, OREGON 97224  
[P] 503-598-8445  
CONTACT: BENJAMIN G. ANDERSON, PE

### OWNERS:

TL 600	WOLVERINE FINANCIAL LLC, LANDCASTER DEVELOPMENT CORPORATION, LONE OAK LAND & INVESTMENT COMPANY LLC 42580 NW CEDAR CANYON RD, BANKS, OR 97106
TL 5200	WOLVERINE FINANCIAL LLC, LANDCASTER DEVELOPMENT CORPORATION, LONE OAK LAND & INVESTMENT COMPANY LLC 42580 NW CEDAR CANYON RD, BANKS, OR 97106

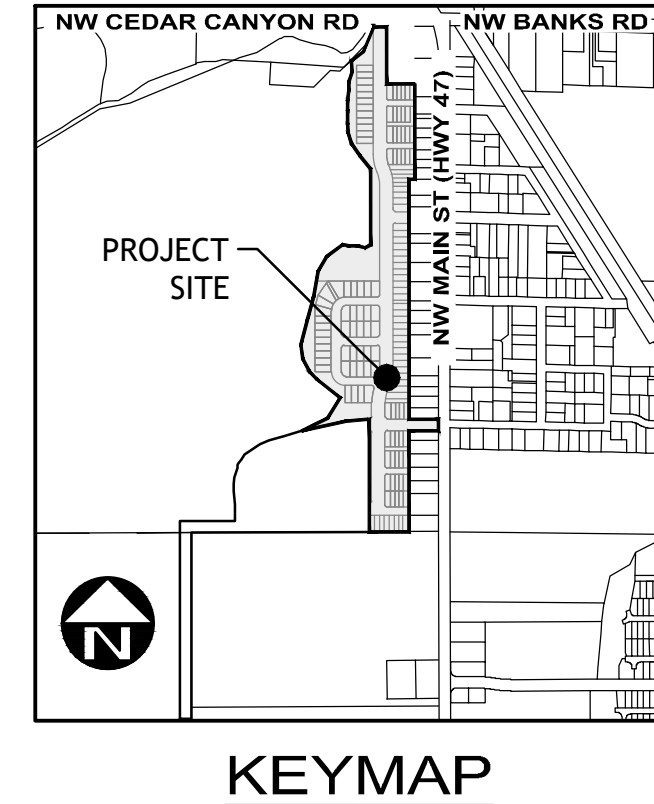
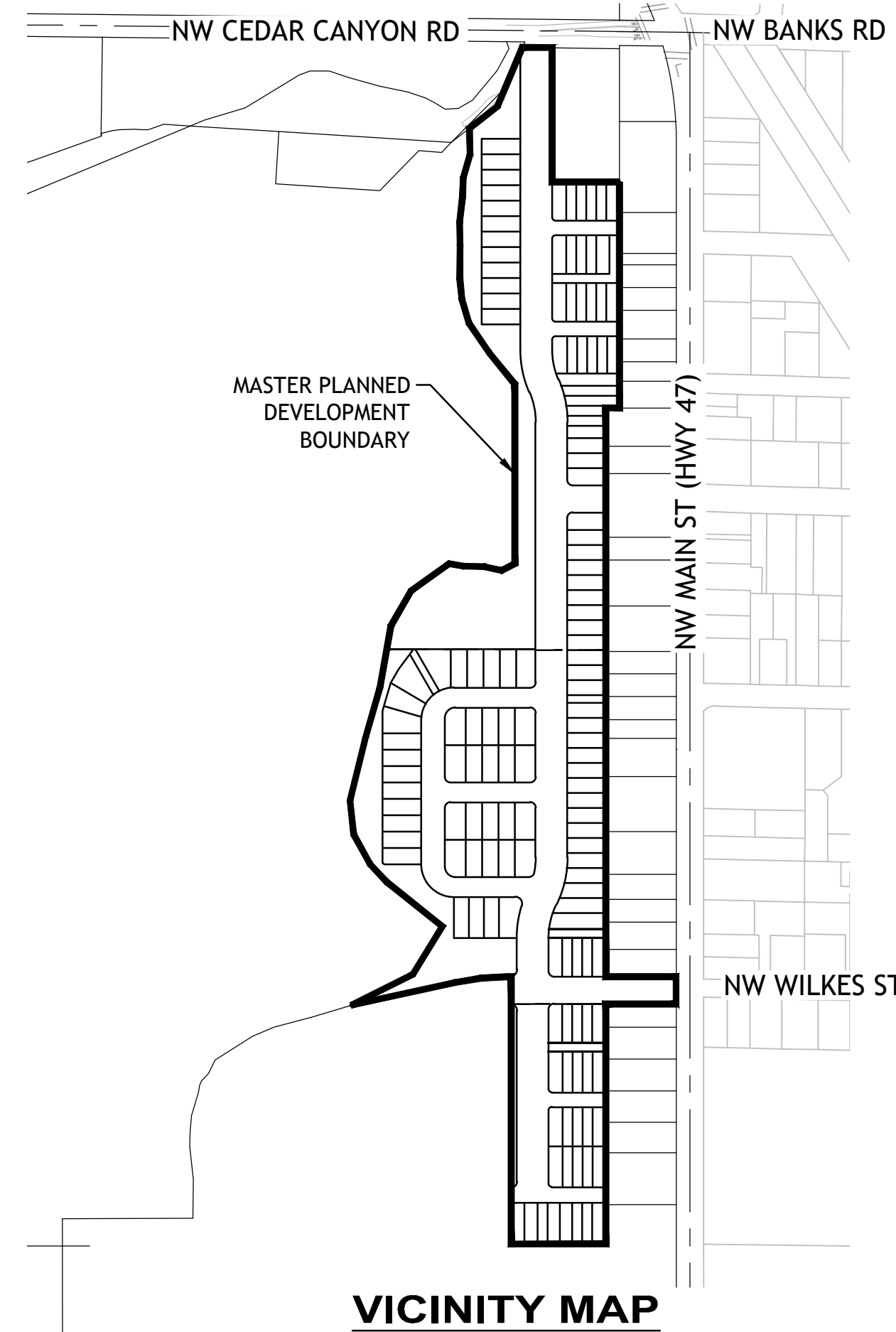

### Sheet List Table

Sheet Number	Sheet Title
1	COVER SHEET
2.1	EXISTING CONDITIONS (PHASE 1)
2.2	EXISTING CONDITIONS (PHASE 2 & 3)
2.3	EXISTING CONDITIONS (PHASE 3)
3	COMPREHENSIVE PLAN & ZONE MAP AMMENDMENTS
4	PARTITION PLAT (PARCEL 1)
5	PARTITION PLAT (PARCEL 2)
6	CONCEPT MASTER PLAN
7	DENSITY & OPEN SPACE CALCULATIONS
8.1	SITE PLAN (PHASE 1)
8.2	SITE PLAN (PHASE 2 & 3)
8.3	VISION CLEARANCE DRIVEWAY DETAIL
9.1	PRELIMINARY PLAT (PHASE 1)
9.2	PRELIMINARY PLAT (PHASE 2 & 3)
10.1	GRADING PLAN (PHASE 1)
10.2	GRADING PLAN (PHASE 2 & 3)
11.1	WATER PLAN (PHASE 1)
11.2	WATER PLAN (PHASE 2 & 3)
12.1	SANITARY SEWER PLAN (PHASE 1)
12.2	SANITARY SEWER PLAN (PHASE 2 & 3)
13.1	STORM SEWER PLAN (PHASE 1)
13.2	STORM SEWER PLAN (PHASE 2 & 3)
14.1	VEHICLE CIRCULATION PLAN
14.2	PEDESTRIAN CIRCULATION PLAN
14.3	ADA CIRCULATION PLAN
15	PARKING PLAN
16.1	TREE PRESERVATION & REMOVAL PLAN (PHASE 1)
16.2	TREE PRESERVATION & REMOVAL PLAN (PHASE 2 & 3)
L1.01	STREET TREE PLANTING PLAN
L1.02	STREET TREE PLANTING PLAN
L1.03	STREET TREE PLANTING PLAN
L2.01	TRAIL WAYFINDING PLAN
L3.01	PARK & TRAIL SITE PLAN
L3.02	PARK & TRAIL SITE PLAN
L3.03	PARK & TRAIL SITE PLAN
L3.04	PARK, TRAIL & OPEN SPACE SITE PLAN
L3.05	OPEN SPACE SITE PLAN
L4.01	STORMWATER PLANTER PLANTING PLAN
L5.01	PLANTING DETAILS
L5.02	DETAILS
L5.03	DETAILS

### LANDSCAPE ARCHITECT:

PACIFIC COMMUNITY DESIGN, INC.  
12564 SW MAIN ST.  
TIGARD, OR 97223  
[P] 765-465-2426  
CONTACT: MICHELLE HUNDLEY, PLA

### NATURAL RESOURCE CONSULTANT:

PACIFIC HABITAT SERVICES LLC  
9450 SW COMMERCE CIRCLE, SUITE 180  
WILSONVILLE, OR 97070  
[P] 503-570-0800  
CONTACT: JOHN VAN STAVERN, PWS, CWD

### TRAFFIC ENGINEER:

KITTELSON & ASSOCIATES, INC  
610 SW ALDER STREET, STE 700  
PORTLAND, OR 97205  
[P] 503-228-5230  
CONTACT: MATT HUGART, PE

WEST  
BANKS

COVER SHEET

PROJECT NO.: 130-004  
TYPE: PLANNING  
REVIEWED BY: JMH

